

# GOGO™

NEMO  
AirSupported Technology™

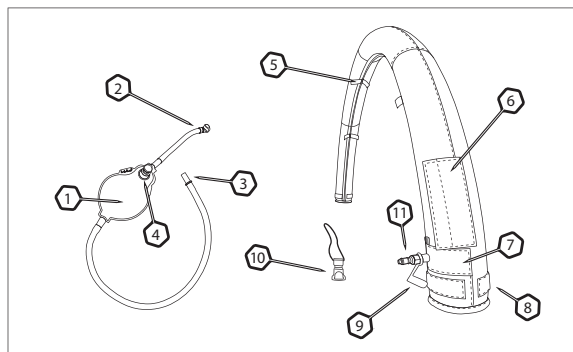

©2006 NEMO Equipment, Inc.

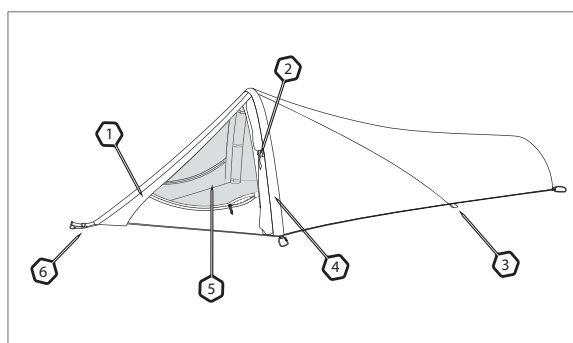

## Gogo™

## OVERVIEW

1. ExoFly™ Retractable Front Rain Fly
2. ExoFly™ Door Tie-backs and Guy-Out Loop
3. Additional Anchors
4. Removable Internal Airbeam
5. Mesh Canopy
6. ExoFly™ Interchangeable Anchor

### Integrated Pump and Airbeam

1. Integrated Pump Body
2. Quick-Disconnect Inflator
3. Mouthpiece
4. Universal Inflation Port / Moisture Release Valve
5. Velcro Straps for Attachment Inside Tent Shell
6. Bladder Access Pocket
7. Hypalon® Valve Reinforcement
8. Velcro Panels for Securing Airbeam Ends
9. Protective Cap for Valve
10. Deflator
11. Quick-Disconnect Inflate/Deflate Valve

[www.nemoequipment.com](http://www.nemoequipment.com)

NEMO EQUIPMENT  
100 Factory Street, Nashua, NH 03060  
Phone/Fax: 1-800-997-9301/ 603-881-9358  
E-mail: [journey@nemoequipment.com](mailto:journey@nemoequipment.com)

\*Patents Pending

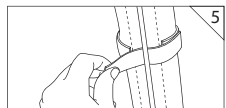
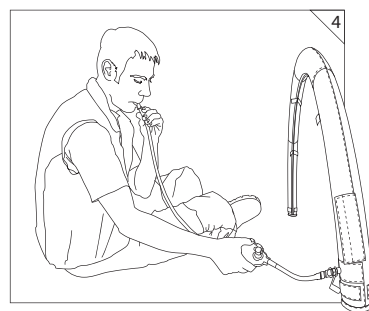
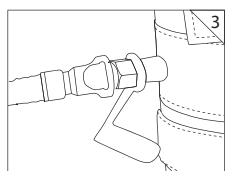
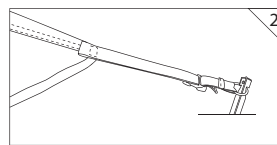
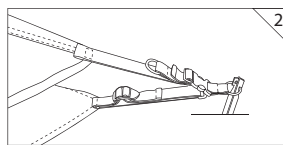
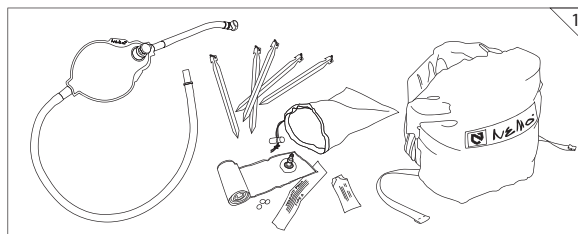

## SET UP

1 Lay out the contents of Gogo™ and make sure you received your tent and the following items: stuff sack (snapped into tent), Integrated Pump, replacement bladder with inflate/deflate valve, 5 stakes, and repair kit. Also confirm that you received any optional items you may have ordered including: Nemoid™ foot pump, T-shirts or accessories.

2 In a flat area, begin the setup of Gogo™ by staking it out. Use the ladder lock to adjust the length the front anchor. When your anchor is properly adjusted, you will be able to use one stake placement to secure either the inner tent or the ExoFly™.

3 Connect your pump to the airbeam. When properly connected, the quick-disconnect fittings will make an audible click.

4 To use the Integrated Pump, first make sure the universal inflation port on top of the pump is closed, then blow into the pump and squeeze it with your hand or under your foot. Repeat this sequence, being sure to frequently inhale. The Integrated pump gives you the option of inflating Gogo™ while protected inside.

5 The first time you set up Gogo™, you will need to attach the airbeam. Line up and attach the Velcro straps. **Keep your airbeam attached to save setup time in the future.**

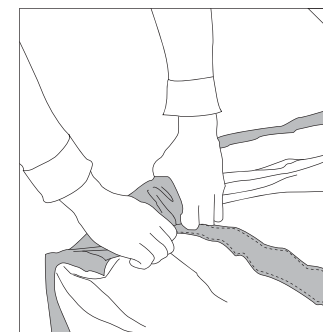
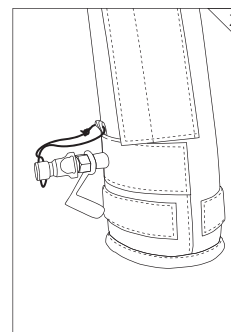

## TAKE DOWN

1 To take Gogo™ down, first remove all gear and as much moisture as possible. Water will add weight to your pack and can lead to mildew.

2 Begin by placing the deflator on the inflate/deflate valve. When properly connected, there will be an audible click. As pressure is released, the airbeam will immediately deflate.

3 Roll the tent along its airbeam towards its valve to force out all of the air. Try to clean as much dirt and debris from your tent as possible before packing it. This will help preserve the breathability of the tent fabrics and reduce overall wear and tear.

4 The stuff sack for Gogo™ doubles as a gear stash pocket inside the tent. To use as a stuff sack, simply turn inside out and begin stuffing the tent. (Hint: you can avoid trapping air if you start stuffing from the foot end)

5 Fold the top edge of the stuff sack down several times to make an airtight seal. Allow excess air to escape while compressing. Secure the stuff sack with the compression straps around the bottom edge.

6 Remember to leave no trace. Before leaving your campsite take a thorough look around making sure you have not left anything behind, out of place, or damaged.

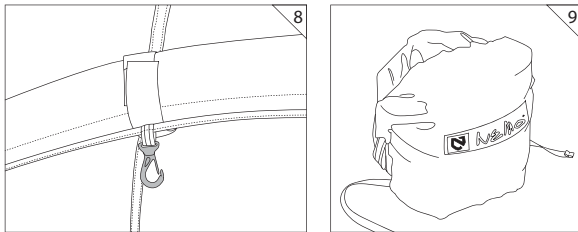
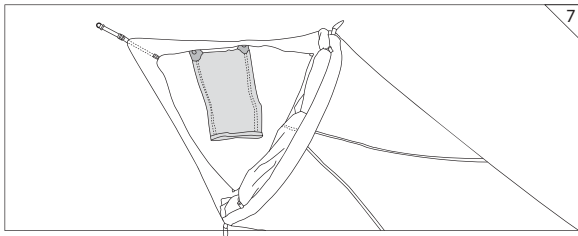
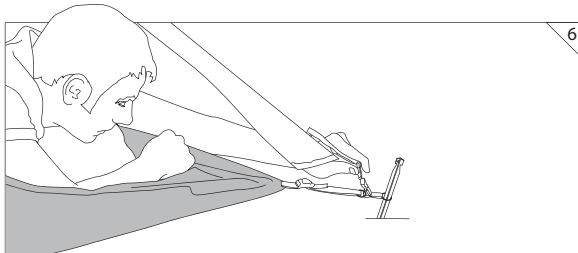
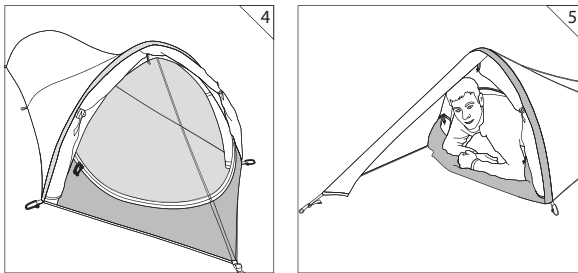
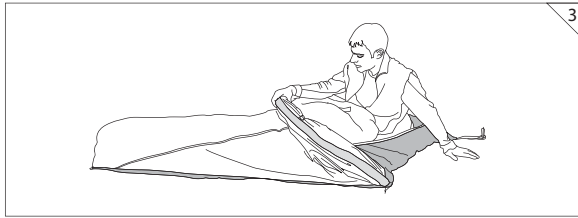
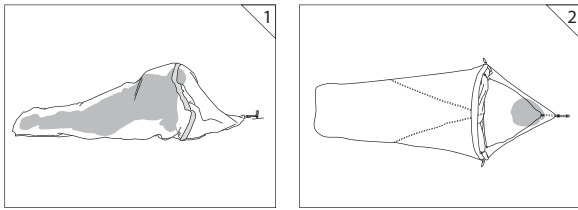

## FEATURES

1 In poor weather, Gogo™ can be inflated entirely from the inside. After staking out the corners, get inside and take your time pumping up the airbeam while staying dry. Remember to close all zippers to stay completely dry.

2 When camping on rock or hard ground, where staking is not possible, stash a few pieces of gear in the very front of your tent. Your body weight in the bivy portion will counter this weight and keep the tent taut.

3 Getting into Gogo™ is as easy as getting into your sleeping bag. When you completely unzip the mesh canopy, you can tilt the airbeam forward to facilitate getting into the tent opening.

4 On sunny days, roll back the entire ExoFly™ to expose as much mesh ventilation as possible. To tie the doors back, put the cord locks through their respective reflective webbing loops, and tighten the cord lock. For privacy or shade, you can choose either half to tie-back or leave down.

5 The ExoFly™ is a unique morphing vestibule that gives you the option of opening space for wet and muddy gear or expanding the inner tent to provide maximum enclosed sleeping room.

6 To create an open vestibule, unhook the front anchor from its stake. Press on the side release buckle to release the inner tent from the ExoFly™. Now re-stake the tent, but this time use the metal ring on the ExoFly™ instead of the one on the inner tent. Retract the inner tent to create as much space as you need. You can clip and unclip from inside the tent by reaching through the front mesh zipper.

7 Nemo AirSupported™ tents are all single-walled which means the entire tent is one piece. There is no assembly of poles or a fly required which saves time and weight. On Gogo™ the stuff sack is also integrated into the tent to provide extra storage and minimize extra weight. Use this pocket to store your pump along with your headlamp, watch, glasses, or any other pieces of gear you may want in an accessible place while you sleep.

8 Use the hook hanging from the center of the airbeam to clip your head lamp for a convenient overhead light.

9 Your Gogo™ stuff sack also works very well as a dry bag for other gear when your tent is not inside. It is waterproof and can double as a pillow when stuffed with your extra clothes.

## CARE & FIELD REPAIR

### Tips for Extending the Life of Your Tent

- △ Avoid rough ground, especially rocks and pavement.
- △ Make sure the tent is clean and dry before packing.
- △ Store the tent unpacked to allow air circulation.
- △ Occasionally inspect the tent for wear and tear.
- △ Don't store the tent exposed to UV light.
- △ Do not store Nemo™ Foot Pump compressed.

### Repairing Bladders:

NEMO AirSupported™ tents are designed to withstand all the usual rigors of adventure. We worked hard to select materials with the right balance of being lightweight and durable. If you take reasonable care of your tent, you should never have a problem. But, accidents do happen! If you have a puncture, the next few steps will show you how to swap in a new bladder and repair the damaged one to keep as a spare. Please read all the steps first before beginning.

### Exchanging Bladders

**! Never open access pockets when airbeam is inflated.**

- 1 △ Connect deflator to completely deflate the punctured airbeam.
- 2 △ Open bladder access pockets. If the puncture is reachable, skip to **Repairing Bladder Punctures** for TEAR-AID™ instructions.

- 3 △ To swap in a new bladder, push the valve back through its Hypalon® hole. A small amount of force may be needed. Be careful not to tear the airbeam.
- 4 △ Tie the new bladder to the end of the old bladder. **It is important as you pull the new bladder through that it does not twist.** To minimize twists, it may help to lay out the new bladder flat on the ground with the valve oriented the right direction.
- 5 △ Pull the new bladder through and untie the old bladder.

6 △ Once the valve is pushed back through its Hypalon® hole and the **access pockets have been closed**, re-inflate.

7 △ Any twists in the bladder will result in kinks in the airbeam when you re-inflate. This will require repeating this entire process, so it is best to take your time and be sure the bladder is fed into the tent with the valve oriented in the right direction, without any twists.

### Repairing Bladder Punctures:

Repairing small holes in a NEMO bladder is simple. If necessary, inflate the bladder underwater to locate the puncture.

- 1 △ Make sure the area is dry and clean
- 2 △ Cover the hole with a generous piece of the self-adhesive patch (TEAR-AID™) included in your repair kit.

If the damage is larger than 1/8" in length or diameter, the repair may not be reliable. Replacement bladders are available from your NEMO retailer or from [www.nemoequipment.com](http://www.nemoequipment.com).

## REPAIR

If you have any problems with a NEMO product, please contact Rainy Pass Repair, Inc., the industry leader in outdoor product care for repair or replacement. If you have any questions regarding warranty and repair, or if you need to send a product in for service, please call Rainy Pass. It is not necessary to clean the item before sending, but it will be appreciated if you remove any excessive soiling. Rainy Pass will be happy to give you advice about safely cleaning your product. Please provide the following when you send a NEMO product to Rainy Pass:

- △ A note with your name, phone number, address, email and problem description. A repair form can be downloaded at: [www.nemoequipment.com/pdf/NEMO\\_repairform.pdf](http://www.nemoequipment.com/pdf/NEMO_repairform.pdf)
- △ Please remove all of your personal items and mark all damaged areas on the product with masking tape.
- △ Pack the product in a sturdy cardboard box with plenty of room. If possible, use the original box to reduce waste.

Ship to:  
Rainy Pass Repair, Inc.  
5307 Roosevelt Way, NE  
Seattle, WA 98105

To contact Rainy Pass:  
Phone: 1 (888) 747-7867  
Email: [repair@rainypass.com](mailto:repair@rainypass.com)  
[www.rainypass.com](http://www.rainypass.com)

If you live in the Seattle area, you can call Rainy Pass locally at (206) 523-8135 and visit their shop during the following hours: M,T,W,F 9am-6pm and Th 9am-7pm.

## WARRANTY

NEMO guarantees every product we sell. We put a great effort into choosing the best materials and providing you with the highest level of workmanship. If one of our products does not meet your expectations during its useful life, we promise to repair it, replace it, exchange it, or give you a refund at our discretion. NEMO does not warranty products against normal wear and tear, unauthorized modifications or alterations, improper use, improper maintenance, misuse or neglect or if the product is used for a purpose for which it is not intended. Except as expressly set forth in these terms and conditions, NEMO is not liable for any direct, indirect or consequential damages arising out of or resulting from the use of a NEMO product. The warranties set forth in these terms and conditions are in lieu of all other warranties, express or implied, including without limitation, implied warranties of merchantability or fitness for a particular purpose.

### ! WARNINGS

- Keep tent away from open flames or smoldering camp fires
- Maintain adequate ventilation inside tent
- Avoid campsites with danger of falling rocks or tree limbs, lightning strikes, flash floods, avalanches or other hazards
- In extreme weather make sure all stakes and guy-outs are secure
- Do not store food inside of tent
- Store tent in a dark, dry area away from UV light