

WindShield™

For ANDI™ and ANDI OZ™

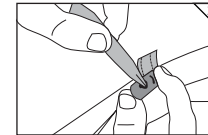

*Patents Pending

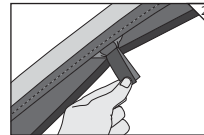
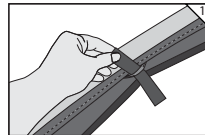

NEMO guarantees every product we sell. We put a great effort into choosing the best materials and providing you with the highest level of workmanship. If one of our products does not meet your expectations during its useful life, we promise to repair it, replace it, exchange it, or give you a refund at our discretion.

To learn more, please visit us at:

www.nemoequipment.com

©2010 NEMO Equipment, Inc. All rights reserved. Made in China.

1. With the NEMO label facing out, place the WindShield™ over the outside of the front door, but under the vestibule. Thread each Velcro™ tab through its corresponding loop on the tent.

2. Moving along the edge of the tent, secure each Velcro™ tab back to itself. There are eight total attachment tabs.

3. Use the cord-lock tie-backs to hold the WindShield™ curtain open when you need it out of the way