



### **NEMO QUALITY**

There is a reason why our logo resembles a medieval shield. If you've ever seen an authentic medieval shield or piece of armor, the detail and quality of craftsmanship are astonishing. Hours were spent shaping and perfecting every component knowing the gravity of purpose and the need for reliable performance. At NEMO, we take the same approach to quality. We know from our own experience how vital a tent can be for comfort and survival. Your tent is your home in the wilderness and your armor against the elements. We obsess over every design decision to ensure you get the greatest comfort and protection possible. Our process begins with pencil and paper and evolves methodically through computer modeling, prototyping, testing and development. We use all the latest tools, software, manufacturing methods and materials. If we aren't happy with what's available we make our own. We strive to design and build the best tents on the planet. We stand behind our shield, the symbol of NEMO quality.

To learn more, please visit our website at [www.nemoequipment.com](http://www.nemoequipment.com).

## NANO ELITE™

Ultra Light for the Ultra Fast.

If you're trying to cover big distances in the backcountry in a hurry, every ounce, every calorie burnt, and every minute spent dealing with your equipment makes a difference. You want your tent to pack tiny, weigh almost nothing, and set up in a snap even when your mind is a blur. Meet Nano Elite™. Made from a superlight nonbreathable 20D fabric, it weighs a paltry 2.8 lbs and takes up less space in your pack than your climbing helmet. A large overhead vent helps to combat condensation and a removable mesh door and a removable mesh door can also be used as an internally adjustable vent when rain isn't a factor. Includes DAC Featherlite® poles, stuff sack, and optional Footprint.

<b>Capacity:</b>	2
<b>Minimum Weight:</b>	2.8 lbs (1.27 kg)
<b>Packed Weight:</b>	3.1 lbs (1.43 kg)
<b>Packed Dimensions:</b>	8" x 7" dia (20 x 18 cm)
<b>Frame:</b>	2 DAC 9/9.6 mm Featherlite®
<b>Shell Fabric:</b>	20 D Sil/PU Nylon Ripstop
<b>Fly Fabric:</b>	N/A
<b>Floor Fabric:</b>	30D PU Nylon Ripstop (5000 mm)
<b>Floor Dimensions:</b>	82" x 56" (208 x 142 cm)
<b>Interior Height:</b>	40" (102 cm)
<b>Floor Area:</b>	26.4 sq ft (2.45 sq m)
<b>Vestibule Area:</b>	N/A



## NANO ELITE™

2/4 PERSON

## Product Features

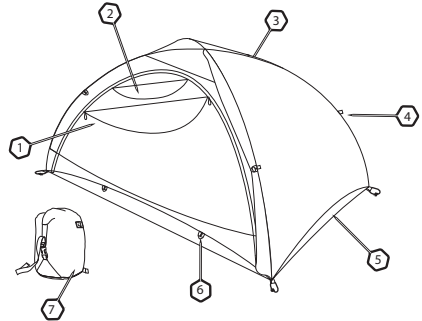

1. Removable Mesh Door (3.1oz)
2. Door
3. Internally Deployable Vent
4. Multiple Guy-Out Points
5. Shell-Tensioning Tub
6. Door Tie-Backs
7. Dry Bag Style Stuff Sack

## NEMO Innovation

**1. 20D Fabric Shell:** Nano Elite™ is a single wall tent, so there is no separate rain fly. The shell of the tent is made of an extremely lightweight 20D fabric with a silicone treatment on the outer surface and a PU treatment on the inner surface. This combination of coatings is waterproof and weighs 35% less than our breathable OSMO™ fabric. However, since the lightweight shell of Nano Elite™ is waterproof but not breathable, condensation should be expected in conditions where wind is light and the air is moist. Nano Elite™ is designed for adventurers who will trade condensation for significant weight savings.

**2. Smart Ventilation:** most double layer doors in tents have the mesh door facing inside and the shell door facing outside. For Nano Elite™ we reversed the door so the mesh is on the outside. By putting the mesh door on the outside, you can quickly reach up in the middle of the night and zip or unzip the inner door to adjust the airflow or keep rain out. We also built a large internally deployable overhead vent into the back wall to provide good cross ventilation.

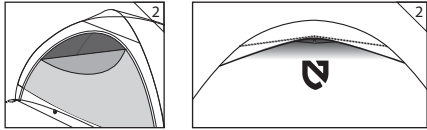

**3. Removable Mesh Front Door:** The mesh front door panel on Nano Elite™ can be unzipped and removed from the tent. The panel weighs 3.1oz, so if you know you're headed somewhere where you don't need protection from insects, you can save the extra weight.



**4. Watertight Dry Bag:** Many of the NEMO tents include watertight dry bags, including the Nano Elite™. Having your tent in a watertight stuff sack means it won't take on water weight if it's in your backpack while you're hiking in the rain, or if it's in your kayak when you roll your boat. Alternatively, if you have to pack your tent wet, it will help keep the rest of the gear in your pack dry.

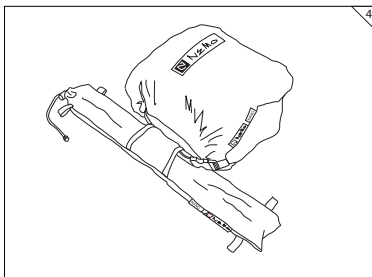

## Tent Setup

1. Lay out the contents of Nano Elite™ and make sure that you received all of the following items: tent, stuff sack, two poles, five stakes, guy lines, pole repair sleeve, Tear-Aid® fabric patches.

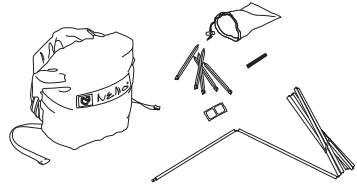

2. When choosing a location to pitch your tent, select a flat area free of fragile undergrowth and sharp objects. Nano Elite™ is a freestanding tent which means it will still function without being staked out. For full strength, anchor the corners of your tent to the ground with the included stakes. If the ground is too hard to place stakes, tie the corners of your tent to heavy objects like rocks. If you are forced to set up your tent on an incline, make sure your head is positioned uphill.

3. To install Nano Elite™ poles, place the end of one pole into a far corner. Insert the opposite end into the diagonal corner near the door. Make sure the pole ends sit in the metal buttons. Repeat with the second pole. It is easiest to insert the poles before staking the tent.

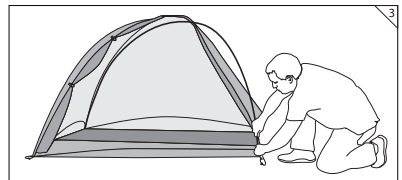
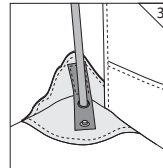

---

## Accessories

---

### Nano Elite™ Footprint

To install the Nano Elite™ Footprint, slip the split rings over each of the four corresponding corner anchors. Make sure the footprint is not exposed under the tent shell or it could collect water in a rain storm.

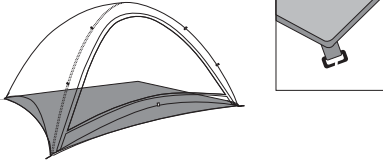

---

## Future Accessories

---

### IRR™ Airbeams

Single wall IRR™ (Integrated Restraint and Retention™) is the latest generation of NEMO AirSupported Technology®. This new method of welding our airbeams combines the properties of our standard airbeam bladder and shell into one advanced composite material. The result is reduced weight and bulk, and more convenient repair. We plan to have IRR™ airbeams available for Nano™ and Nano OZ™ in 2009.

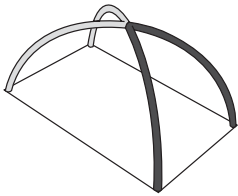

---

## Tent Take Down

---

1. To take Nano Elite™ down, first remove all gear and as much moisture as possible. Water will add weight to your pack and can cause mildew.
2. From inside Nano Elite™, undo all of the Velcro® pole wraps. Use the pull tabs to make unwrapping easier.
3. Fully open the door of the tent and remove the poles from the tent starting by pulling the ends closest to the door out through the doorway. Fold the poles and insert them into the pole stuff sack.
4. Stuff the tent entirely into the stuff sack. By starting with the back end of Nano Elite™ you will avoid trapping air in your stuff sack.

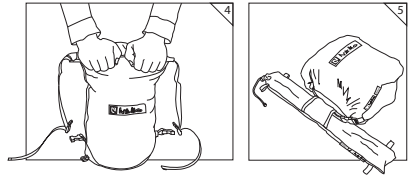

5. Fold the top edge of the stuff sack down several times to make an air-tight seal. Allow excess air to escape while compressing. Secure the stuff sack with the compression straps on both sides.

---

## Storage

---

Remember to dry your tent out completely before storing as moisture can lead to mildew. Also try to remove as much dirt and debris from your tent as possible. Avoid storing your tent compressed or exposed to UV light for long periods.

---

## Tips for Extending the Life of Your Tent

---

- △ Avoid rough ground, especially rocks and pavement.
- △ Make sure the tent is clean and dry before packing.
- △ Store the tent unpacked to allow air circulation.
- △ Occasionally inspect the tent for wear and tear.
- △ Do not store the tent exposed to UV light.
- △ Do not store Nemoid™ Foot Pump compressed.

---

## Poles

---

- △ "A tree fell on my tent and one of the poles was broken!"

First, make sure you are OK, and then direct your attention to the tent. The best way to fix a broken pole is with the repair sleeve that came with your tent. If the pole is cracked or broken cleanly, the repair sleeve should slide in place over the damaged area. If the pole is bent or has a burr around the break, it may be necessary to cut or file the damaged area. A temporary fix may be possible by taping another pole or extra tent stake alongside the damaged area. Contact NEMO to order replacement poles.

---

## Fabric

---

- △ "I sliced my tent on a sharp tree branch!"

We use a ripstop weave pattern to prevent tears from expanding in the fabrics, but tears can happen. Make sure the area you choose to set up your tent is free of sharp rocks, sticks, or thorns. Take care when using any sharp tools near your tent! Remember that your tent is your home in the mountains and it's made of lightweight fabric. Small tears in the fly can be reinforced with the included Tear-Aid patch on the inside of the fabric. The Tear-Aid will only stick well to the inside of the fly. Larger areas can be hand-stitched and sealed with Seamgrip®, or you can send your tent to Rainy Pass for repair. (See information on next page).

- △ "My tent has a mildew smell."

Always pack and store your tent dry! Mildew is not only smelly and bad for the tent materials, it is also unhealthy. Contact Rainy Pass Repair for advice about safely removing mildew.



---

## NEMO Repair

---

If you have any problems with a NEMO® product, please contact Rainy Pass Repair, Inc., the industry leader in outdoor product care, for repair or replacement. If you have any questions regarding warranty and repair, or if you need to send a product in for service, please call Rainy Pass. It is not necessary to clean the item before sending, but it will be appreciated if you remove any excessive soiling. Rainy Pass will be happy to give you advice about safely cleaning your product. Please provide the following when you send a NEMO® product to Rainy Pass:

- △ A note with your name, phone number, address, e-mail and problem description. A repair form can be downloaded at:  
[www.nemoequipment.com/pdf/NEMO\\_repairform.pdf](http://www.nemoequipment.com/pdf/NEMO_repairform.pdf)
- △ Mark all damaged areas on the product with masking tape.
- △ Pack the product in a sturdy cardboard box with plenty of room. If possible, use the original box to reduce waste.

Ship to:  
Rainy Pass Repair, Inc.  
4415 Stone Way North  
Seattle, WA 98103

To contact Rainy Pass:  
Phone: 1.888.747.7867  
Email: [repair@rainypass.com](mailto:repair@rainypass.com)  
[www.rainypass.com](http://www.rainypass.com)

---

## NEMO Warranty

---

NEMO® guarantees every product we sell. We put great effort into choosing the best materials and providing you with the highest level of workmanship. If one of our products does not meet your expectations during its useful life, we promise to repair it, replace it, exchange it, or give you a refund at our discretion. NEMO® does not warranty products against normal wear and tear, unauthorized modifications or alterations, improper use, improper maintenance, misuse or neglect or if the product is used for a purpose for which it is not intended. Except as expressly set forth in these terms and conditions, NEMO® is not liable for any direct, indirect or consequential damages arising out of or resulting from the use of a NEMO® product. The warranties set forth in these terms and conditions are in lieu of all other warranties, express or implied, including without limitation, implied warranties of merchantability or fitness for a particular purpose.



## NEMO Green

Our spirit is in adventure. Without the beautiful wild places where adventures are made, our spirit dies. Please join us in protecting the planet and preserving the places where our spirit thrives.

NEMO is a small company but even small companies and individuals can make a difference. Here are some of the green efforts we are currently making:

>We are incorporating sustainability into our product designs with innovations like our 90% recycled/recyclable Nano OZ™ tent, bamboo tent poles and our Ditto™ reusable tote bag made from old tent samples.

>As of 2008, all of our aluminum poles from DAC use a more environmentally friendly anodization process that avoids the use of toxic heavy metals. These poles are also recyclable.

>In 2006 we stopped using PVC in all of our products.

>All of our business partners domestically and overseas run responsible businesses with good working conditions and respect for the environment.

>NEMO employees get one day off every month to pursue a green effort or volunteer with a community organization.

>In 2008, NEMO adopted the northern end of Jenness Beach in North Hampton, NH (a favorite surf spot of many NEMO employees) through the Blue Ocean Society. The adoption enables NEMO to keep the beach clean throughout the year and also track the types of debris to determine whether the trash is ocean-based or land-based.





>NEMO donates to many groups such as the Access Fund and the National Wildlife Federation to help preserve the natural places we cherish. We have also donated tents to help with disaster relief, including donating over 150 winter mountaineering tents to Pakistan in 2005 following the earthquake in Kashmir.

>NEMO provides discounts and donates tents to college outing clubs to encourage students to get outdoors and foster a love for the environment.

>We recycle everything possible in our shop, including re-using packaging materials and we encourage our manufacturing partners to do the same.

>We do as much of our printing as possible on recycled paper with environmentally-friendly inks.



<p>Never place your stove, campfire, or other flame source in or near your tent. Never cook, light, or refuel a stove or any other heat source inside your tent. Death by suffocation and/or serious burns is possible.</p>	<p>Maintain adequate ventilation inside your tent at all times. Death by suffocation is possible.</p>	<p>Anchor your tent properly at all times to reduce the risk of loss or injury to the tent or occupants.</p>	<p>Carefully consider the possibility of falling rocks or tree limbs, lightning strikes, flash floods, avalanches, strong winds, and other hazards when choosing a campsite to reduce the risk of loss or injury.</p>
<p><b>NO FIRE</b></p>	<p><b>VENTILATION</b></p>	<p><b>ANCHOR</b></p>	<p><b>CAMPSITE</b></p>
			



## WARNING

If you have additional questions, please contact  
NEMO Equipment, Inc. directly at 800-997-9301  
[www.nemoequipment.com](http://www.nemoequipment.com).

NOTE: All 2009 NEMO tents meet the CPAI-84 standard for flame retardancy.



### NEMO MISSION

Our 2008 product line is the result of 6 years of devoted labor and half a million years or so of developing better tools for shelter and survival. NEMO is about what we have just discovered and what we have known for a long time. It's about beautiful design and intelligent engineering. It's about serene cloudless days and bitter cold nights spent battling snow drifts and frostbite. It's about bringing two worlds together: the world of design and technology and the actual world where we test ourselves and our inventions. We are pursuing perfection. It is an epic journey, often elusive, demanding youthful energy, creativity and courage. We have come a long way in our travels and we promise never to yield in our determination. Like our ancestors who explored new places for the first time, we will change the common idea of what is possible.

Please visit us at: [www.nemoequipment.com](http://www.nemoequipment.com)

NEMO EQUIPMENT, INC.  
100 FACTORY ST, NASHUA, NH 03060  
P: 800-997-9301 F: 603-881-9358



Printed on Recycled Paper



[www.nemoequipment.com](http://www.nemoequipment.com)

©2009 NEMO Equipment, Inc.