

MOKI™



©2007 NEMO Equipment, Inc.



OVERVIEW

Moki™

1. Internal Poles
2. Zipper for Vestibule Attachment
3. External Poles
4. PU Weather Window
5. Internally Deployable Strutted Vents
6. Side Door
7. 2nd Main Door
8. Pole Sleeves
9. Multiple Guy-out Points
10. Reinforced Corner Pockets
11. Door Tie-backs

Vestibule and Cheez™

12. PU Weather Checking Window
13. Zip-on Vestibule
14. Upper Vestibule Panel
15. Connection Panel
16. Cheez™ Insulation (Sold Separately)

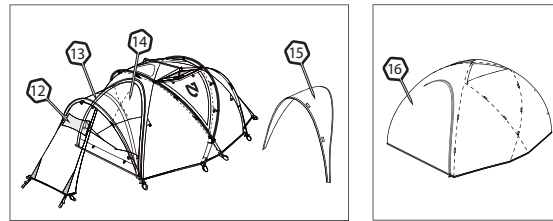
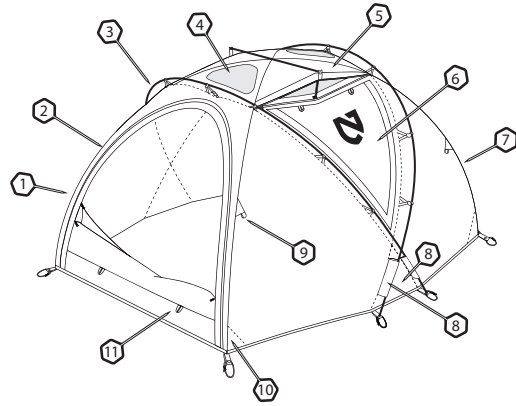

www.nemoequipment.com

NEMO EQUIPMENT INC.
100 Factory Street, Nashua, NH 03060
Phone: 1-800-997-9301
E-mail: journey@nemoequipment.com

*Patents Pending

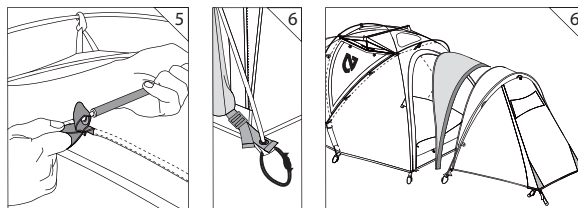
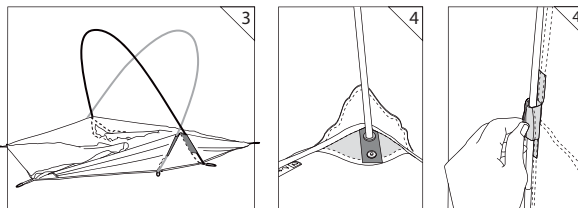
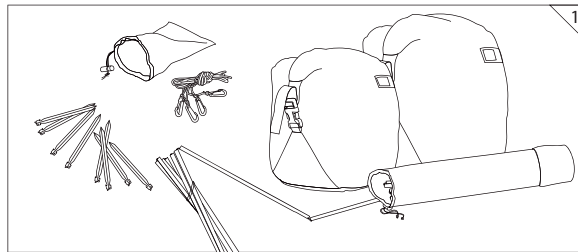

SET UP

- 1 Lay out the contents of Moki™ and make sure that you received your tent and the following: 4 long poles, one short pole, curved vestibule pole, vestibule, upper vestibule panel, connection panel with red Velcro, pole stuff sack, dry bag style stuff sack, 10 stakes, guy lines, Seamgrip® with nozzle, Tear-aid™ fabric repair patches and pole repair sleeve.
- 2 Seam sealing adds strength and waterproofness to tent. It needs at least 24 hours to cure before using. See insert with included Seamgrip®.
- 3 Begin the setup of your tent by staking it out on level ground. Insert one end of a black pole through pole sleeve and into grommet on red webbing. Place other end of pole through opposite pole sleeve and into grommet on red webbing. Repeat with second pole in the grommets on black webbing. Clip tent to poles.
- 4 The corners of Moki™ are reinforced to receive the ends of the orange interior poles. Place pole ends in button snaps at corners. Use the Velcro wraps to secure the poles along the inside of the tent shell.
- 5 Insert short pole into grommets on webbing between top vents. Use finger loops to help get the pole in and out.
- 6 Zip the upper vestibule panel to the vestibule and to the tent. Slide the vestibule pole through the sleeve. Attach pole to grommets in tent anchors. Then attach vestibule grommets to pole ends and tighten webbing to hold vestibule in place. Stake out the vestibule front corners.

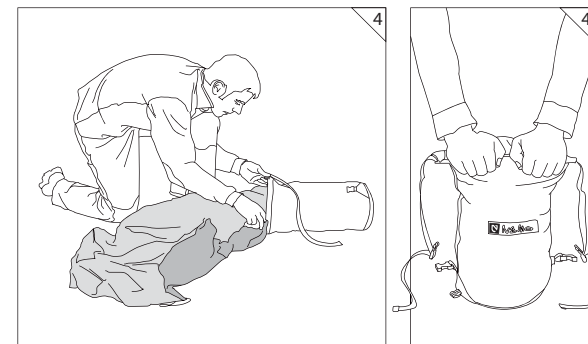
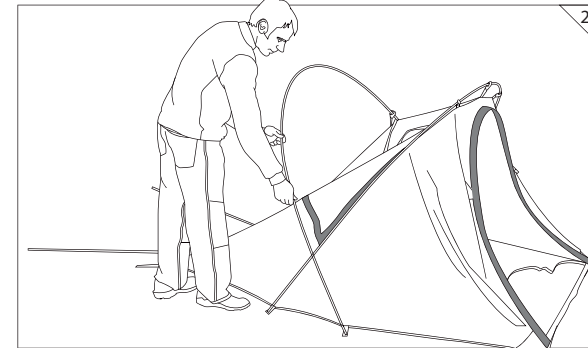

TAKE DOWN

- 1 To take down Moki™, first empty tent, remove accessories (including the vestibule, Pawprint™, and Cheez™ insulation), and shake out moisture and debris. Water will add weight to your pack and can lead to mildew.
- 2 Unclip and remove the exterior poles. Carefully pull the interior poles out through the main door. If the pole wraps bind to the interior poles, it may be necessary to detach them before removing the poles.
- 3 Try to clean as much dirt and debris from your tent as possible before packing it. This will help preserve the breathability of the tent fabrics and reduce overall wear and tear.
- 4 Stuff the tent shell into its dry bag style stuff sack. Fold the top edge of the stuff sack down several times to make an airtight seal. Allow excess air to escape while compressing. Secure the stuff sack with the compression straps on both sides. Place the poles into the pole bag. See features section for more about modular packing of Moki™.
- 5 Remember to leave no trace even in winter. Before leaving your campsite take a thorough look around making sure you have not left anything behind, out of place, or damaged.

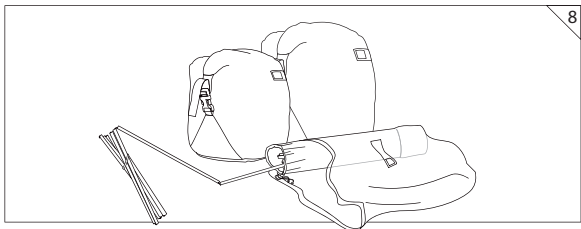
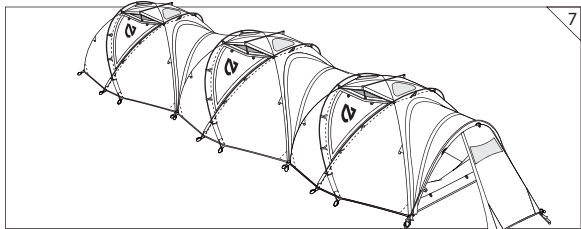
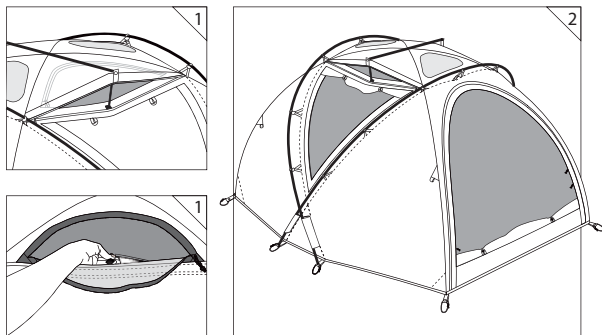

FEATURES

1 Ventilation is key to a comfortable night, especially in poor weather. Moki™ has two large overhead vents to move moisture out of the tent. The vents can be strutted open or zipped closed from inside or outside the tent. **WARNING:** Improper ventilation can lead to suffocation.

2 Moki™ is designed to be comfortable in all four seasons, no matter the weather. You can convert roughly half of Moki's™ shell to mesh by tying back its four large doors. Guy out the side doors and open the overhead vents to provide maximum ventilation in the rain. Add Cheez™ insulation (sold separately) for added warmth on the coldest nights.

3 Side doors add extra exits and provide a convenient way to load gear in and out of the tent. Open the door and stand up for a morning stretch or brush your teeth without having to put your shoes on.

4 On cold nights setup the Cheez™ (sold separately) between your tent shell and poles and attach using the Velcro tabs. This extra layer of metallized breathable fabric will reflect body heat and significantly increase the warmth of the tent.

5 If you purchased Moki's™ removable, washable interior floor lining, the Pawprint™, you can insert it with the snaps and Velcro along the edge of the floor. Now you can share your tent with your dog or bring your muddy shoes inside and wash the floor when you get home. The surface of the Pawprint™ is microbrushed for comfort and creates a non-slip surface for sleeping pads.

6 The included full vestibule is great for storing wet or dirty gear. It provides protection in the rain and the option of a dry entry. It is designed so that one or both eaves can be left open without letting rain inside the tent. An additional vestibule can be purchased for extra storage and work space. If the sun comes out, you can easily unzip and remove your vestibule. **WARNING:** do not cook in or near your tent. This can lead to burns or suffocation.

7 Setting up a base camp or travelling with a crowd? The unique vestibule design of Moki™ allows two or more tents to connect. Use one tent as a sleeping quarters and the other for gear storage or as a gathering place. To connect tents, zip a connector panel to an upper vestibule panel and join them to the tents where the vestibules would have attached. The connector panel is similar to the upper vestibule panel but has red Velcro.

8 Moki™ is a three person tent and it comes with enough stuff sacks to divide the tent into multiple portions for easier carrying. There is a dry bag style stuff sack for the Moki™ tent shell and vestibule. This bag offers maximum compressibility and doubles as a dry place for other gear. The optional Cheez™ comes with an additional dry bag style stuff sack. Both of these dry bags fit snugly inside the Moki™ carrying bag for storage or when one person is carrying the entire tent. The Moki™ carrying bag includes an integral pole bag. To use the pole bag alone, simply invert the carrying bag into the small pouch at the bottom of the pole bag.

CARE & FIELD REPAIR

Tips for Your Tent's Longevity:

- △ Avoid rough ground, especially rocks and pavement.
- △ Make sure it is clean and dry before packing the tent.
- △ Store the tent unpacked to allow air circulation.
- △ Occasionally inspect the tent for wear and tear.
- △ Don't store the tent exposed to UV light.

Seam Sealing

△ "I woke up in a puddle!"

Did you seam seal your tent? Pole wraps and Cheez™ attachments are sewn directly through the tent to create a very strong hold. Water can work its way through these stitches if not properly waterproofed. Use included Seamgrip® to cover stitching on Velcro pole wraps and Velcro Cheez™ attachments inside tent (See below.) Seamgrip® can also be used on all exterior sewn seams, but is not necessary. **Allow to dry overnight.** Note that Seamgrip® can stick to itself even after curing, so it is best to lightly dust fully cured areas with talcum powder. Please visit www.mcnett.com for more information.

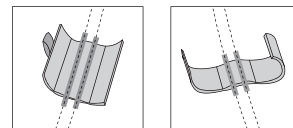

REPAIR

If you have any problems with a NEMO product, please contact Rainy Pass Repair, Inc., the industry leader in outdoor product care for repair or replacement. If you have any questions regarding warranty and repair, or if you need to send a product in for service, please call Rainy Pass. It is not necessary to clean the item before sending, but it will be appreciated if you remove any excessive soiling. Rainy Pass will be happy to give you advice about safely cleaning your product. Please provide the following when you send a NEMO product to Rainy Pass:

- △ A note with your name, phone number, address, email and problem description. A repair form can be downloaded at: www.nemoequipment.com/pdf/NEMO_repairform.pdf
- △ Please remove all of your personal items and mark all damaged areas on the product with masking tape.
- △ Pack the product in a sturdy cardboard box with plenty of room. If possible, use the original box to reduce waste.

Ship to:	To contact Rainy Pass:
Rainy Pass Repair, Inc.	Phone: 1 (888) 747-7867
5307 Roosevelt Way, NE	Email: repair@rainypass.com
Seattle, WA 98105	www.rainypass.com

If you live in the Seattle area, you can call Rainy Pass locally at (206) 523-8135 and visit their shop during the following hours: M,T,W,F 9am-6pm and Th 9am-7pm.

Fabric

△ "I sliced my tent while digging it out during a storm!"

Damaging tents while shoveling them out on big mountains is a common problem. Take care when using sharp tools near your tent! Remember that your tent is your home in the mountains and it's made of lightweight fabric. Shovel most of the snow away and shake the rest off the tent or cover your shovel with a stuff sack or length of tape to protect the tent fabric from the shovel's sharp edges. Small tears can be reinforced with Seamgrip®. Larger areas can be hand-stitched and sealed with Seamgrip®, or you can send your tent to Rainy Pass for repair. (See information below)

△ "My tent has a mildew smell."

Always pack and store your tent dry! Mildew is not only smelly and bad for the tent materials, it is also unhealthy. Contact Rainy Pass Repair (see below) for advice about safely removing mildew.

Poles

△ "My tent was caught in an avalanche and one of the poles was broken!"

The best way to fix a broken pole is with the repair sleeve that came with your tent. If the pole is cracked or broken cleanly, the repair sleeve should slide in place over the damaged area. If the pole is bent or has a burr around the break, it may be necessary to cut or file the damaged area. A temporary fix may be possible by taping another pole or extra tent stake alongside the damaged area. Contact NEMO to order replacement poles.

WARRANTY

NEMO guarantees every product we sell. We put a great effort into choosing the best materials and providing you with the highest level of workmanship. If one of our products does not meet your expectations during its useful life, we promise to repair it, replace it, exchange it, or give you a refund. NEMO does not warranty products against normal wear and tear, unauthorized modifications or alterations, improper use, improper maintenance, misuse or neglect or if the product is used for a purpose for which it is not intended. Except as expressly set forth in these terms and conditions, NEMO is not liable for any direct, indirect or consequential damages arising out of or resulting from the use of a NEMO product. The warranties set forth in these terms and conditions are in lieu of all other warranties, express or implied, including without limitation, implied warranties of merchantability or fitness for a particular purpose.

! WARNINGS

- Keep tent away from open flames or smoldering camp fires
- Maintain adequate ventilation inside tent
- Avoid campsites with danger of falling rocks or tree limbs, lightning strikes, flash floods, avalanches or other hazards
- In extreme weather make sure all stakes and guy-outs are secure
- Do not store food inside of tent
- Store tent in a dark, dry area away from UV light